

**MONTEREY PENINSULA WATER MANAGEMENT DISTRICT**

**ADDENDUM NO. 1  
TO  
CONTRACT DOCUMENTS**

**For Construction  
Of  
SANTA MARGARITA WATER TREATMENT FACILITY PROJECT**

**GENERAL**

*Scope*

The following revisions are made to the Contract Documents and its attachments for the subject project.

This Addendum (including attachments), dated August 27, 2019, includes 16 pages.

**ADDITIONAL INFORMATION**

The **bid opening date and time** have been changed to Thursday September 19, 2019 at 2:00 p.m. The location will be the same at 5 Harris Court, Building G, Monterey, CA 93940.

Questions will be accepted up to 5:00 pm on Thursday September 12, 2019.

Work must be substantially complete on or before June 30, 2020.

**REVISIONS**

***Item No. 1***

Construction Technical Specifications, 015500 Owner Furnished Contractor Installed (OFCI) Items

Please be aware Prominent Chlorine Residual Analyzer Assemblies are ***not*** being purchased by the Owner. The Contractor is responsible for purchasing the Prominent Chlorine Residual Analyzer Assemblies.

Delete 1.02 (C) in its entirety.

**Item No. 2**

Attachment C – Geotechnical Investigation and Update to the Geotechnical Investigation Report

Change the title to “*Attachment C – Geotechnical Investigation and Updates*”

Add the Exhibit A of this Addendum 1 to the Bid Documents Attachment C. Exhibit A is an addition to Attachment C, it does not replace Attachment C.

**Item No. 3**

Special Conditions, 2. Equipment Substitutions

Add the following in its entirety:

*“Findings were made by the MPWMD Board of Directors on August 19, 2019 that specific brands for equipment have been designated pursuant to Public Contract Code 3400 (c) (2) for the following equipment:*

- *Prominent Chemical Feed Systems*
- *Prominent Chlorine Analyzers*
- *Hach Turbidimeter*
- *ClaVal Co Modulating Valves*
- *Sparling Tigermag Magnetic Flowmeters*
- *Poly Processing Co chemical tanks*

*Findings designating brand name equipment were **not** made for the following equipment:*

- *Yokogawa Conductivity Probe*
- *Westfall Static Mixers*
- *Westfall Flow Conditioners*
- *Safe-T Flow Chemical Injectors*
- *Weldon PVC primer*
- *Spears PVC Basket Strainers*
- *March Manufacturing Magnetic Drive Pumps “*

**Item No. 4**

Construction Technical Specifications, 172150 Process Fluid Analyzers 2.1 (A)

Please be aware analyzers with no substitutes are designated in Product Data sections.

Delete “*No substitutions.*”

**Item No. 5**

Construction Technical Specifications, 172150 Process Fluid Analyzers 2.3 (D) (8) (c)

*Replace "No substitutes." with "Or equal. The Engineer has researched the above items and found that it is uniquely suited for this project because of its performance characteristics, materials of construction and chemical compatibility, and/or dimensional features due to site constraints; as such it has no known equal. If the Contractor believes that there is another product that meets all of the above requirements, submit product details for review and consideration at least 5 calendar days BEFORE the bid opening date; the Engineer will determine equivalency and notify all bidders within 48 hours thereafter as to its acceptability.*

*If the Contractor chooses to wait until AFTER contract award to have the product reviewed and the Engineer determines that the product is not equal, Contractor shall provide the item originally specified without any additional compensation. The Engineer shall be solely responsible for the determination of equivalency, and the Engineer's decision shall be final."*

**Item No. 6**

Construction Technical Specifications, 151220 Piping Specialties (Static Mixers, Flow Conditioners, Steel Couplings, Transition Couplings, and Flanged Coupling Adaptors) Part 2 – Materials (A) Static Mixers.

Delete strikethrough text shown:

*"Static mixers ~~(4 required)~~ shall be manufactured by Westfall Manufacturing, sold through Safe- T- Flow Water Services (714) 632-3013. ~~No substitutions shall be allowed.~~ Static mixers shall be Westfall Model 6000, size 16" ~~(2 req'd)~~ and 20" ~~(2 req'd)~~,"*

Add the following in its entirety:

*"Or equal. The Engineer has researched the above items and found that it is uniquely suited for this project because of its performance characteristics, materials of construction and chemical compatibility, and/or dimensional features due to site constraints; as such it has no known equal. The equipment must fit within the piping layout presented in the Construction Plan Drawings is also required. If the Contractor believes that there is another product that meets all of the above requirements, submit product details for review and consideration at least 5 calendar days BEFORE the bid opening date; the Engineer will determine equivalency and notify all bidders within 48 hours thereafter as to its acceptability.*

*If the Contractor chooses to wait until AFTER contract award to have the product reviewed and the Engineer determines that the product is not*

*equal, Contractor shall provide the item originally specified without any additional compensation. The Engineer shall be solely responsible for the determination of equivalency, and the Engineer's decision shall be final."*

**Item No. 7**

Construction Technical Specifications, 151220 Piping Specialties (Static Mixers, Flow Conditioners, Steel Couplings, Transition Couplings, and Flanged Coupling Adaptors) Part 2 – Materials (B) Flow Conditioners.

Delete strikethrough text shown:

*"Flow Conditioners shall be manufactured by Westfall Manufacturing, sold through Safe-T-Flow Water Services (714) 632-3013. ~~No substitutions shall be allowed.~~ Flow Conditioners shall be Westfall Model 3000, size 16" (2 req'd) and 20" (2 req'd),"*

Add the following in its entirety:

*"Or equal. The Engineer has researched the above items and found that it is uniquely suited for this project because of its performance characteristic, materials of construction and chemical compatibility, and/or dimensional features due to site constraints; as such it has no known equal. Additionally the items must be from the same manufacturer as the static mixers. If the Contractor believes that there is another product that meets all of the above requirements, submit product details for review and consideration at least 5 calendar days BEFORE the bid opening date; the Engineer will determine equivalency and notify all bidders within 48 hours thereafter as to its acceptability.*

*If the Contractor chooses to wait until AFTER contract award to have the product reviewed and the Engineer determines that the product is not equal, Contractor shall provide the item originally specified without any additional compensation. The Engineer shall be solely responsible for the determination of equivalency, and the Engineer's decision shall be final."*

**Item No. 8**

Construction Technical Specifications, 151220 Piping Specialties (Static Mixers, Flow Conditioners, Steel Couplings, Transition Couplings, and Flanged Coupling Adaptors) Part 2 – Materials (C) Safe-T Flow Chemical Injectors.

Delete strikethrough text shown:

*"(4 required). Injection quill assemblies (2 ea.) for the 16" spool shall be **HC-100-H-T-7-B-V**. For the 20" Spools (2 ea.), **HC-100-H-T-9-B-V**. ~~No substitutions shall be allowed.~~"*

Add the following in its entirety:

*"Or equal. The Engineer has researched the above items and found that it is uniquely suited for this project because of its performance*

*characteristics, materials of construction and chemical compatibility, and/or dimensional features due to site constraints; as such it has no known equal. Additionally the equipment must provide functionality such that it can be serviced and inspected while the main is still pressurized. If the Contractor believes that there is another product that meets all of the above requirements, submit product details for review and consideration at least 5 calendar days BEFORE the bid opening date; the Engineer will determine equivalency and notify all bidders within 48 hours thereafter as to its acceptability.*

*If the Contractor chooses to wait until AFTER contract award to have the product reviewed and the Engineer determines that the product is not equal, Contractor shall provide the item originally specified without any additional compensation. The Engineer shall be solely responsible for the determination of equivalency, and the Engineer's decision shall be final."*

**Item No. 9**

Construction Technical Specifications, 335299 PVC Piping, Valves, and Misc. Accessories 2.04 (A) (4)

Delete strikethrough text shown:

~~"Cement: Solvent weld, ASTM F-493, IPS 724 PVC by Harrington Plastics or Weldon 724 PVC; no other equal. PVC primer shall be Weldon P-70 only, no substitutions."~~

Add the following in its entirety:

*"Or equal. The Engineer has researched the above items and found that it is uniquely suited for this project because of its performance characteristics, materials of construction and chemical compatibility, and/or dimensional features due to site constraints; as such it has no known equal. If the Contractor believes that there is another product that meets all of the above requirements, submit product details for review and consideration at least 5 calendar days BEFORE the bid opening date; the Engineer will determine equivalency and notify all bidders within 48 hours thereafter as to its acceptability.*

*If the Contractor chooses to wait until AFTER contract award to have the product reviewed and the Engineer determines that the product is not equal, Contractor shall provide the item originally specified without any additional compensation. The Engineer shall be solely responsible for the determination of equivalency, and the Engineer's decision shall be final."*

**Item No. 10**

Construction Technical Specifications, 335299 PVC Piping, Valves, and Misc. Accessories 2.05 (F) (1)

Delete strikethrough text shown:

~~"PVC Basket Strainers shall be Spears Co. Model BS33P8-020, with FKM O-Ring seal; flanged connection, 2" size, 8 mesh basket. No substitutions allowed."~~

Add the following in its entirety:

*"Or equal. The Engineer has researched the above items and found that it is uniquely suited for this project because of its performance characteristics, materials of construction and chemical compatibility, and/or dimensional features due to site constraints; as such it has no known equal. If the Contractor believes that there is another product that meets all of the above requirements, submit product details for review and consideration at least 5 calendar days BEFORE the bid opening date; the Engineer will determine equivalency and notify all bidders within 48 hours thereafter as to its acceptability."*

*If the Contractor chooses to wait until AFTER contract award to have the product reviewed and the Engineer determines that the product is not equal, Contractor shall provide the item originally specified without any additional compensation. The Engineer shall be solely responsible for the determination of equivalency, and the Engineer's decision shall be final."*

**Item No. 11**

Construction Plans and Specifications, 112120 Centrifugal Pumps 2.03 (A)

Delete strikethrough text shown:

~~"No substitutions will be allowed for the transfer pumps nor the Chemical Room sump pumps. Mount each pump / motor assembly in accordance with Manufacturer's recommendations."~~

Add the following in its entirety:

*"Or equal. The Engineer has researched the above items and found that it is uniquely suited for this project because of its performance characteristics, materials of construction and chemical compatibility, and/or dimensional features due to site constraints; as such it has no known equal. If the Contractor believes that there is another product that meets all of the above requirements, submit product details for review and consideration at least 5 calendar days BEFORE the bid opening date; the Engineer will determine equivalency and notify all bidders within 48 hours thereafter as to its acceptability."*

*If the Contractor chooses to wait until AFTER contract award to have the product reviewed and the Engineer determines that the product is not equal, Contractor shall provide the item originally specified without any additional compensation. The Engineer shall be solely responsible for the determination of equivalency, and the Engineer's decision shall be final."*

**Item No. 12**

Notice Inviting Sealed Bids, first paragraph

Delete in its entirety:

*"NOTICE IS HEREBY GIVEN that sealed bids will be received by the Monterey Peninsula Water Management District (MPWMD) at 5 Harris Court, Building G, Monterey, California, 93940 until 2:00 pm Wednesday September 11, 2019, at which time they shall be publicly opened and read."*

Add in its entirety:

*"NOTICE IS HEREBY GIVEN that sealed bids will be received by the Monterey Peninsula Water Management District (MPWMD) at 5 Harris Court, Building G, Monterey, California, 93940 until 2:00 pm **Thursday September 19, 2019**, at which time they shall be publicly opened and read."*

**Item No. 13**

Notice Inviting Sealed Bids, last sentence

Delete in its entirety:

*"Questions may be directed to mhamilton@mpwmd.net prior to 5:00 pm Thursday September 5, 2019."*

Add in its entirety:

*"Questions may be directed to mhamilton@mpwmd.net prior to 5:00 pm Thursday September 12, 2019."*

**Item No. 14**

Notice Inviting Sealed Bids, third paragraph

Delete in its entirety:

*"Work must be substantially complete on or before May 31, 2020 as defined in the Special Conditions."*

Add in its entirety:

*"Work must be substantially complete, as defined in the Special Conditions, on or before June 30, 2020."*

**Item No. 15**

Instructions to Bidders, Timing, last sentence

Delete in its entirety:

*“Work must be substantially complete on or before May 31, 2020 as defined in the Special Conditions.”*

Add in its entirety:

*“Work must be substantially complete, as defined in the Special Conditions, on or before June 30, 2020.”*

**Item No. 16**

Bid Acknowledgement

Delete in its entirety:

*“The work must be substantially completed by May 31, 2020 so that the works and facility are operational, and the remaining work must be completed by September 31, 2019.”*

Add in its entirety:

*“The work must be substantially completed by June 30, 2020 so that the works and facility are operational, and the remaining work must be completed by September 31, 2019.”*

**Item No. 17**

Contract Agreement, 2. Time of Performance

Delete in its entirety:

*“In accordance with the Specifications, the undersigned further agrees to so plan the work and to prosecute it with such diligence that the backflush basin expansion work must be substantially completed by May 31, 2020 so that the works and facility are operational, and the remaining work must be completed by September 31, 2020.”*

Add in its entirety:

*“In accordance with the Specifications, the undersigned further agrees to so plan the work and to prosecute it with such diligence that the work must be substantially completed by June 30, 2020 so that the works and facility are operational, and the remaining work must be completed by September 31, 2020.”*

**Item No. 18**

Construction Plan Drawing A101.

Sheet has been revised to show where the building underdrain ties into the existing drains on site.



Delete old Sheet A101 in its entirety.

Add the Construction Plan A101, noted as "Bid Addendum #1, 8-27-2019" in revision block, included in this Addendum 1 as Exhibit B.

## **QUESTIONS AND RESPONSES**

None

## Exhibit A

Intentional blank

August 20, 2019

Project No. 0922.2-M242-E12

Mr. Steve Tanner, PE  
Pueblo Water Resources  
4478 Market Street, Suite 705  
Ventura, CA 93003

**Subject:** **Geotechnical Investigation Report Addendum**  
MPWMD – ASR Site Expansion  
Backflush Pit at Santa Margarita Well Site  
1910 General Jim Moore Boulevard  
Seaside, California

**Reference:** **Pacific Crest Engineering, Inc.**  
Geotechnical Investigation For New Electrical & Chemical Feed Building  
Project No. 0922-M242-E12  
Dated April 30, 2009

Update to Geotechnical Investigation Report  
Project No. 0922.1-M242-E12

**WRD Architects LLP**  
Plan Set For Chlorination Building – MPWMD Santa Margarita ASR Facility  
Sheets C1 – C6, revised 6-24-19  
Sheets S1.0, S2.0, S3.0, S4.0, S4.1, revised 6-25-19

Dear Mr. Tanner,

As requested, we are providing this addendum letter to the above referenced geotechnical investigation and update reports prepared by our firm in 2009 and 2018, respectively. The purpose for this letter is to evaluate the proposed improvements in order to develop geotechnical recommendations pertinent to the proposed construction of a new chlorination building and related improvements located to the west of the existing retention pond. The recommendations outlined below are based on our review of the referenced soil reports, geotechnical review of the civil and structural plan set provided by your office (referenced above), and our prior work at the site during construction of the retention pond expansion.

Based on our review of the referenced June 2019 plan set, it is our understanding that the proposed improvements will consist of construction of a new chlorination building, a chemical loading rack along the northwest side of the retention basin, and related access road/parking improvements.

The proposed improvements are presently underlain by fill ranging from approximately one to four feet in depth. The chlorination building will be constructed of CMU walls with concrete slab-on-grade floors and spread footings founded approximately 4 to 5 feet below existing grades. Based on the proposed finish floor elevations and review of the structural drawings it appears that the chlorination building will be founded on both engineered fill and native soil.

## UPDATED RECOMMENDATIONS

Based on our review of the proposed improvement plans, it is our opinion that, except as modified below, the recommendations of our 2009 and 2018 reports continue to remain applicable to this project. All recommendations of the 2009 Geotechnical Report and subsequent updates should be closely followed during the design and construction phases of the project. Any unexplained discrepancies between the original report and subsequent updates should be brought to the immediate attention of the Geotechnical Engineer for clarification.

The chlorination building chemical rooms will be founded approximately 5 feet below existing grades, therefore extending below any engineered fill and bearing upon native soil of unknown density. The electrical room, storage and entry levels will be at or near existing grades and are expected to be underlain by engineered fill. In order to establish uniform bearing conditions beneath the building and reduce the potential for differential settlement, we recommend all footings be underlain by a minimum of 12 inches of engineered fill in order to establish uniform bearing conditions below the entire structure. The zone of engineered fill should extend a minimum of 2 feet laterally beyond the footing perimeter.

Engineered fill should be placed and compacted according to the recommendations of the referenced geotechnical reports. We recommend a minimum of 90% compaction below all footings. The upper 12 inches of subgrade below all concrete slab-on-grade should be compacted to a minimum of 95%.

Based on our geotechnical review of the referenced plan set, we offer the following comments:

Sheet S2.0, Foundation Notes: Currently, ACI 302-1R and Section 4.505.2 of the 2016 California Green Building Standards Code recommend that interior concrete slab floors be placed directly upon the vapor retarder, with **no sand cushion**.

Sheet S4.0, Detail 1: We recommend full drainage be provided behind the CMU wall as shown on Detail 5 of the same sheet.

This report is issued as an addendum to our April 30, 2009 geotechnical report and February 23, 2018 update and should be reviewed in conjunction with those documents. Except as modified herein, all other recommendations of our April 2009 geotechnical report and subsequent updates remain applicable to the design and construction of the project.

We respectfully request an opportunity to review any subsequent revisions to the project plans and specifications to confirm that our recommendations of this report have been included and to provide additional recommendations, if needed. These plan review services are also typically required by the reviewing agency. Misinterpretation of our recommendations or omission of our requirements from the



project plans and specifications may result in changes to the project design during the construction phase, with the potential for additional costs and delays in order to bring the project into conformance with the requirements outlined within this report.

We appreciate the opportunity to be of service. If you have any questions regarding this update letter, please contact our office.

Sincerely,

PACIFIC CREST ENGINEERING INC.

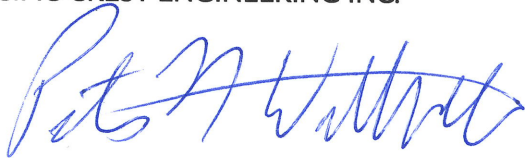

Peter Wildvine  
Geotechnical Construction Manager



Elizabeth M. Mitchell, GE  
President/Principal Geotechnical Engineer  
GE 2718, Expires 12/13/20



Copies: 2 to Client



## Exhibit B

Intentional blank

KEY NOTES

THE KEY NOTES THAT FOLLOW APPLY TO THE DRAWING(S) ON THIS SHEET ONLY. REFER TO FOLLOWING SHEETS FOR NOTES THAT ARE APPLICABLE TO THOSE DRAWINGS.

- 1

NEW BUILDING ACCESS DRIVEWAY INCLUDING PARKING
- 2

EXISTING WALL AND FENCING
- 3

NEW BUILDING
- 4

NEW CONC. PAVING, SEE DETAIL 1/ A111
- 5

NEW ROLLING GATE

5A

CONCRETE / STEEL TRACK, SEE DETAIL 3/A111

5B

GATE MOTOR ON CONCRETE PAD, SEE DETAIL 4/A111

5C

STEEL TUBE ROLLING GATE WITH WOOD CLADDING, SEE DETAILS 4/A111 AND 5/A111

- 6

SLIDING GATE CONTROL - KEYPAD STATION
- 7

SLIDING GATE CONTROL - SENSOR LOOP IN DRIVEWAY
- 8

FOUNDATION SUB DRAIN SYSTEM

8A

APPROXIMATE LOCATION OF EXISTING SITE AREA DRAIN SYSTEM

8B

NEW SUB DRAIN FOUNDATION PIPE, 4" PERFORATED SCHEDULE 40 PVC PIPE, SEE DETAIL 5/S4.0 FOR INVERT HEIGHT

8C

NEW SUB DRAIN DRAINAGE PIPE, 4" SOLID SCHEDULE 40 PVC PIPE, SLOPE 1% MIN. TO P.O.C. AT EXISTING AREA DRAIN SYSTEM PIPE, VERIFY EXACT LOCATION (E) INVERT FOR NEW DRAIN P.O.C. PRIOR TO PROCEEDING WITH ANY NEW DRAIN INSTALLATION WORK

MPWMD SANTA MARGARITA ASR FACILITY  
CHLORINATION BUILDING

1910 GENERAL JIM MOORE BLVD.  
SEASIDE, CA

JOB NO.:  
18014.2  
PRINT DATE:  
PLOT DATE: 8.28.2019  
CHECKED BY:  
SET ISSUED:  
80% DESIGN REVIEW 5/17/19  
100% DESIGN REVIEW 6/25/19  
ISSUED FOR BID 8/5/19  
BID ADDENDUM 8/27/19

SHEET NAME:  
PARTIAL  
SITE  
PLAN  
SHEET NO.:

A101

FILE NAME: 18014.2 A101

WR&D

WALD RUHNKE & DOST  
ARCHITECTS LLP

2340 GARDEN ROAD, SUITE 100  
MONTEREY, CALIFORNIA 93940  
PHONE: 831.649.4642  
FAX: 831.649.3530  
WWW.WRDARCH.COM

THE USE OF THE PLANS AND SPECIFICATIONS IS RESTRICTED TO THE ORIGINAL SITE FOR WHICH THEY WERE PREPARED AND PUBLICATION THEREOF IS EXPRESSLY LIMITED TO SUCH USE. REUSE, REPRODUCTION OR PUBLICATION BY ANY METHOD IN WHOLE OR IN PART IS PROHIBITED. TITLE TO THE PLANS AND SPECIFICATIONS REMAINS WITH THE ARCHITECT, AND VISUAL CONTACT WITH THEM CONSTITUTES PRIMA FACIE EVIDENCE OF THE ACCEPTANCE OF THESE RESTRICTIONS.

GENERAL JIM MOORE BLVD.

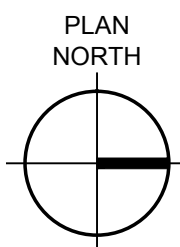
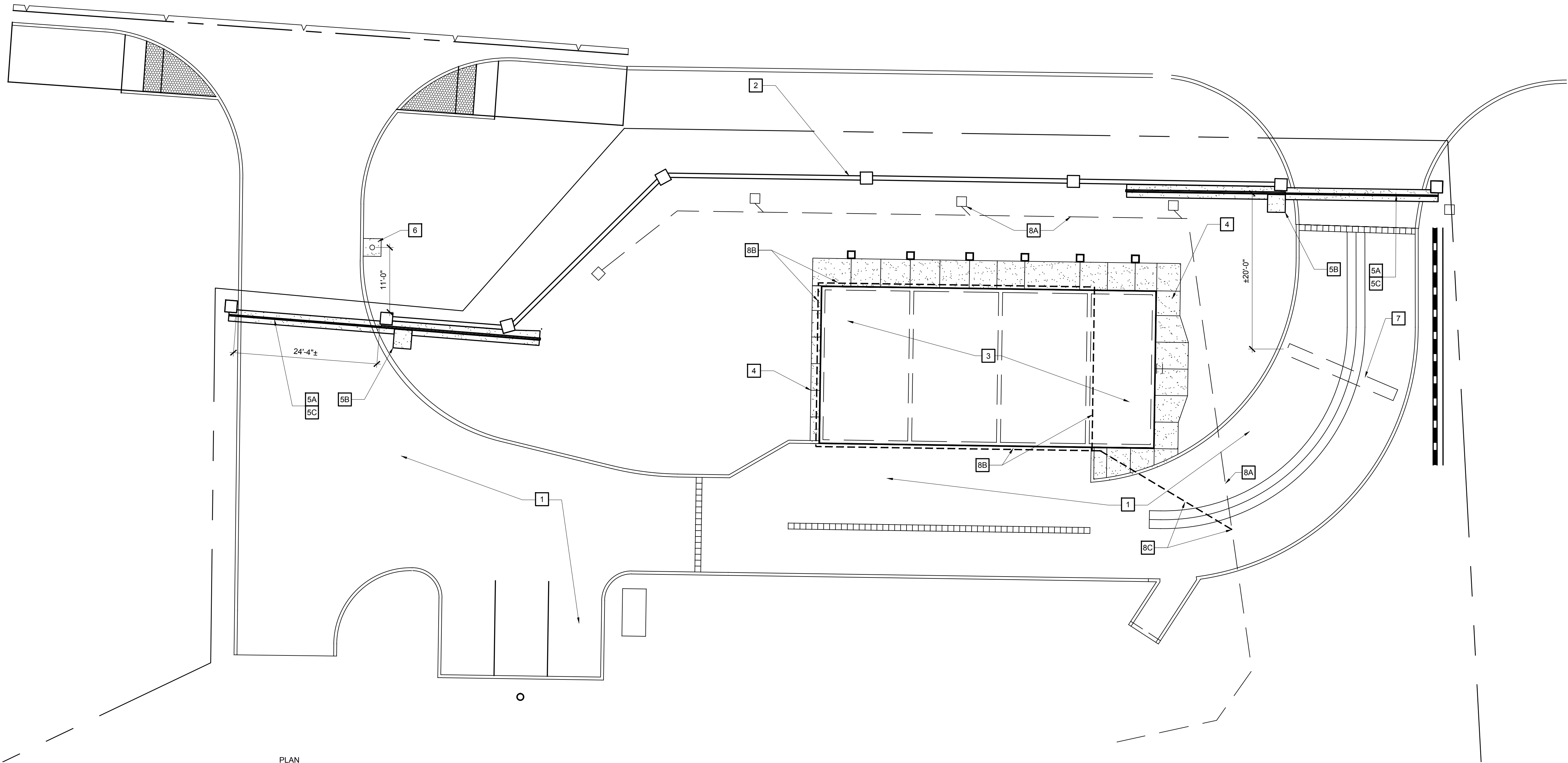

PARTIAL SITE PLAN  
SCALE: 1" = 10'-0"

**End of Addendum No. 1**